

**UNITED**  
WATER PRODUCTS



# **FIREFLO**

**DRY BARREL FIRE HYDRANT**

**MODEL F-06**

**AWWA C-502**

**250 PSI OPERATING PRESSURE**

**500 PSI TEST PRESSURE**

# FEATURES

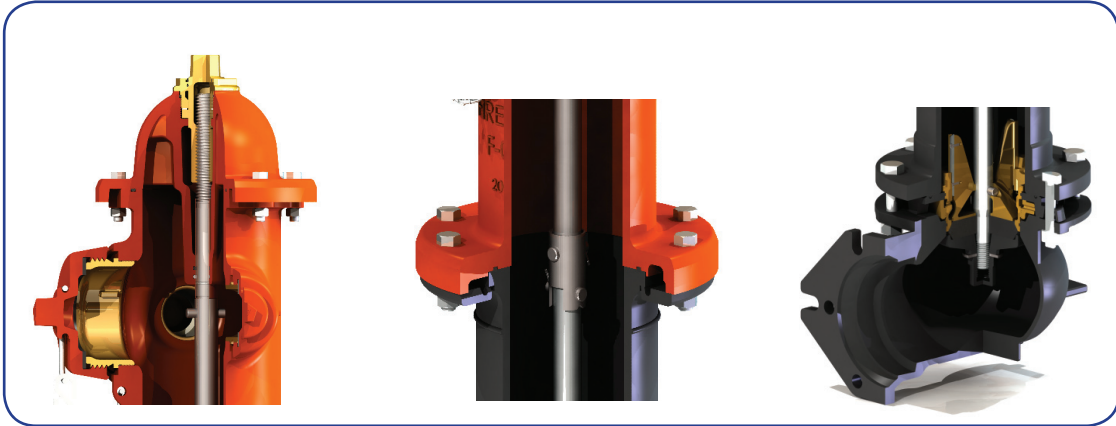

- **Anti-friction washer** lends to a smoother functioning hydrant.
- **Brass oil filler plug** is located on the top section of the bonnet, so that the oil level may be easily checked
- **O-ring seals for oil reservoir** keeps water out and oil in. Assures self lubrication.
- **Safety stem coupling** is made from corrosion resistant stainless steel. If the hydrant is impacted by a vehicle, the stem coupling disengages the stem from the main valve. The lower stem is protected from the vehicles tire because it remains below the flange of the lower barrel. Also, the coupling will not shatter due to the impact and the hydrant should be relatively easy to repair.
- **Traffic safety flange** is designed to break without shattering if the hydrant is impacted by a vehicle. It is also designed for relatively easy installation of an extension or to rotate the direction of the nozzles.
- **Drain Ring Housing** is fusion bonded epoxy powder coated ductile iron to prevent corrosion.
- **Upper Valve Plate** is made from bronze and designed for a smooth flow.
- **Bronze Drain Ring** is bronze to bronze facing, designed for long life and effective sealing.
- **Cap Nut** is fusion bonded epoxy powder coated ductile iron to prevent corrosion.
- **Base Elbow** is fusion bonded epoxy powder coated ductile iron to prevent corrosion and to offer superior flow characteristics.

- **Integral Hold Down Nut - Weather Seal** - The integral hold down nut prevents unauthorized intrusion. The integral weather seal prevents external entry of water and dirt. The wiper seal and bonnet o-ring are produce from UV resistant Buna-N.
- **Standards** meet or exceed the requirements of ANSI/AWWA C502 Standard.
- **O-Ring seats** on base elbow and bonnet are superior sealing and relatively easy to replace.
- **Oil Reservoir** keeps the bearing surfaces and stem fully lubricated every time the hydrant is opened or closed.
- **Low Friction Loss** - Large I.D.'s and smooth radius pumper and hose nozzles create a lower friction loss.
- **Hose and Pumper Nozzles** - 5-1/4" main valve opening 3-way (two hose nozzles and one pumper nozzle). Made from high grade bronze and screwed into the hydrant body with stainless steel locking pins and o-ring sealed. They are relatively easy to replace if required.
- **Stainless Steel Nuts and Bolts** provide superior corrosion protection below ground.
- **Hose and Pumper Chains** are a specially designed connecting loop to prevent kinking.
- **Valve Seat Ring** is double o-ring sealed and accurately machined bronze and screwed into the drain. Above ground removal is relatively easy, if required. Every time the valve is operated, the ports flush the drain valve openings to fully drain the upper and lower barrels.

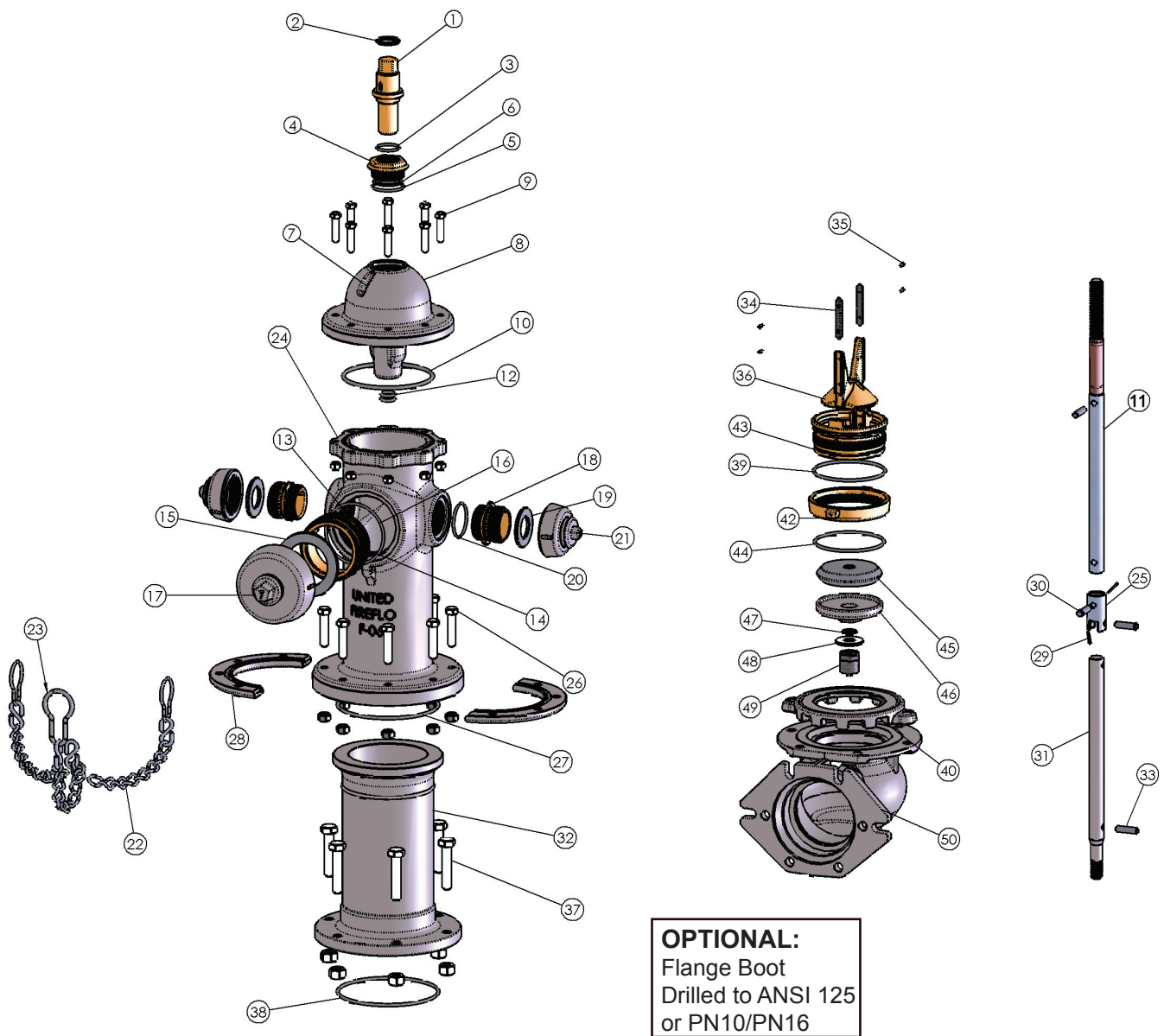

Item No.	Description	Material	Specification	Qty. Req'd	Item No.	Description	Material	Specification	Qty. Req'd
1	Operating Nut	Bronze	ASTM B584	1	26	Safety Flange Bolts & Nuts	Steel	ZPS, A307	8
2	Weather Seal	Rubber	ASTM D2000, BUNA N	1	27	Safety Flange O-Ring	Rubber	ASTM D2000, BUNA N	1
3	Hold Down Nut O-Ring	Rubber	ASTM D2000, BUNA N	1	28	Safety Flange	Cast Iron	ASTM A126, CL-B	2
4	Hold Down Nut	Bronze	ASTM B584	1	29	Cotter Pin	Stainless Stl.	ASTM A276	2
5	Bonnet O-Ring	Rubber	ASTM D2000, BUNA N	1	30	Clevis Pin	Stainless Stl.	ASTM A276	2
6	Anti-Friction Washer	PTFE	-	1	31	Lower Rod	Steel	ASTM A576 Gr-B	1
7	Oil Plug	Brass	ASTM B16	1	32	Standpipe Lower (Specify Bury)	Cast Iron	ASTM A126, CL-B	1
8	Bonnet	Cast Iron	ASTMA126, CL-B	1	33	Stem Pin	Stainless Stl.	ASTM A276	2
9	Bonnet Bolts & Nuts	Steel	ZPS, A307	8	34	Drain Valve Facing	Plastic	-	2
10	Bonnet O-Ring	Rubber	ASTM D2000, BUNA N	1	35	Drain Valve Screw	Stainless Stl.	ASTM A276	4
11	Upper Rod	Steel	ASTM A576, Gr-B	1	36	Valve Top Plate	Bronze	ASTM B584	1
12	Upper Rod O-Ring	Rubber	ASTM D2000, BUNA N	2	37	Elbow & D.R.H. Bolts & Nuts	Stainless Stl.	SS304	6
13	Nozzle Lock Key	Stainless Stl.	ASTM A276	3	38	Drain Ring Housing O-Ring	Rubber	ASTM D2000, BUNA N	1
14	Pumper Nozzle	Bronze	ASTM B584	1	39	Seat Ring O-Ring (Top)	Rubber	ASTM D2000, BUNA N	1
15	Pumper Nozzle Gasket	Rubber	ASTM D2000, BUNA N	1	40	Drain Ring Housing	Ductile Iron	ASTM A536	1
16	Pumper Nozzle O-Ring	Rubber	ASTM D2000, BUNA N	1	42	Drain Ring	Bronze	ASTM B584	1
17	Pumper Nozzle Cap	Cast Iron	ASTM A126, CL-B	1	43	Seat Ring	Bronze	ASTM B584	1
18	Hose Nozzle	Bronze	ASTM B584	2	44	Seat Ring O-Ring (Bottom)	Rubber	ASTM D2000, BUNA N	1
19	Hose Nozzle Gasket	Rubber	ASTM D2000, BUNA N	2	45	Main Valve	Rubber	ASTM D2000, BUNA N	1
20	Hose Nozzle O-Ring	Rubber	ASTM D2000, BUNA N	2	46	Valve Botton Plate	Ductile Iron	ASTM A536	1
21	Hose Nozzle Cap	Cast Iron	ASTM A126, CL-B	2	47	Cap Nut Seal	Rubber	ASTM D2000, BUNA N	1
22	Cap Chain	Steel	Plated	3	48	Lock Washer	Stainless Stl.	ASTM A276	1
23	Chain Ring	Steel	Plated	3	49	Valve Botton Plate Nut	Ductile Iron	ASTM A536	1
24	Standpipe Upper	Cast Iron	ASTM A126, CL-B	1	50	Elbow	Ductile Iron	ASTM A536	1
25	Safety Coupling	Stainless Stl.	ASTMA890	1	51	Lubricant (in Chamber)	Mineral Oil	Food Grade	1

Note:  
 Part #'s 40, 46, 49 & 50 are Fusion Bonded Epoxy, inside and out, complying with AWWA C550.



**UNITED**  
Water  
Products

2113 W. 30th Street, P.O. Box 12010, Jacksonville, FL 32209  
Tel: 877-766-4459 • Fax: 877-766-4458  
Website: [www.unitedwaterproducts.com](http://www.unitedwaterproducts.com)

FH0611